

PLANTA GENERAL SEMISOTERRANI)

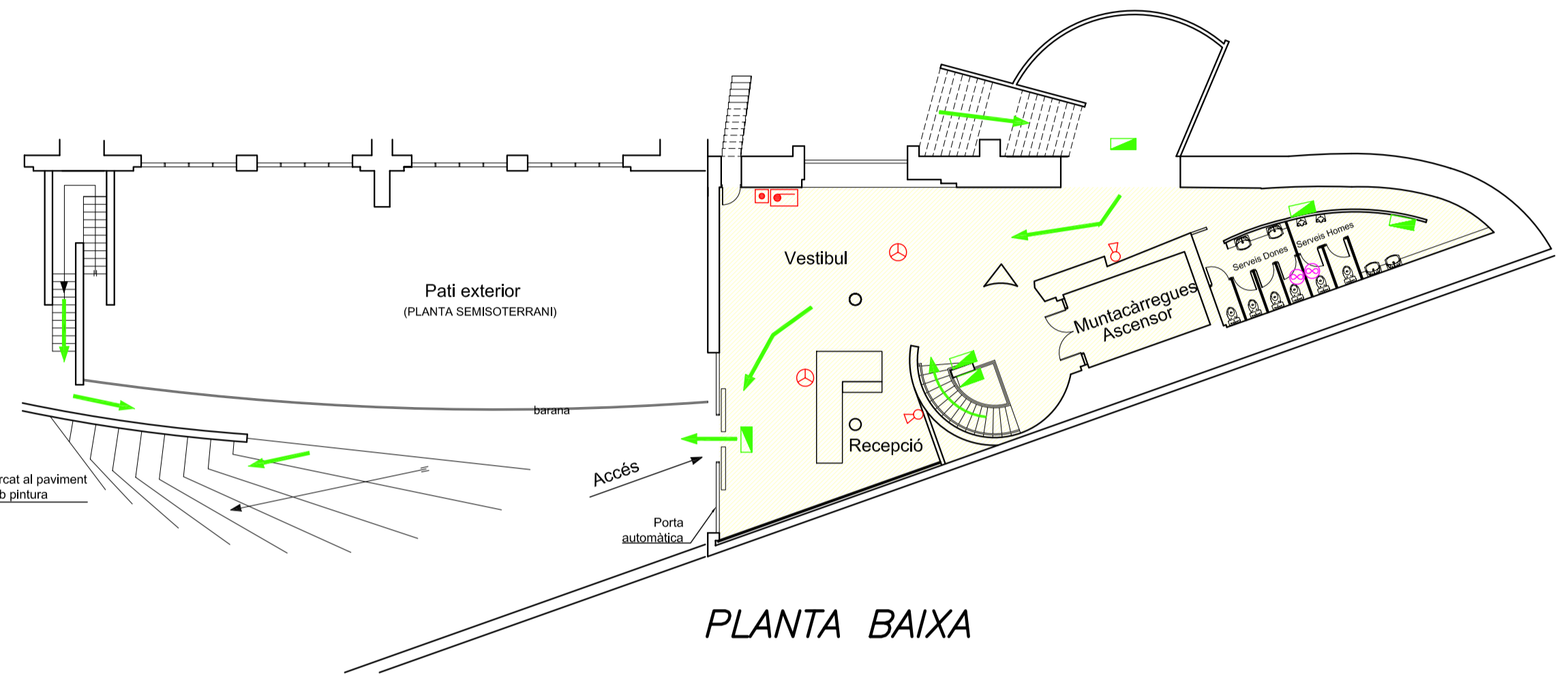

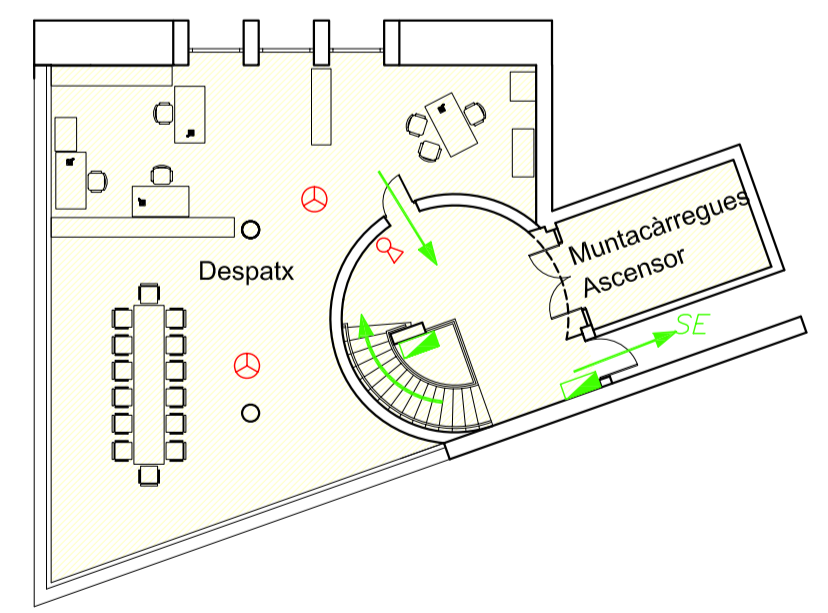

















PLANTA BAIXA



PLANTA PRIMERA

LLEGENDA

-  QUADRE ELÈCTRIC
-  EXTINTOR POLS POLIVALENT (6 KG)
-  EXTINTOR CO2 (5 KG.)
-  B.I.E. ø 25 mm.
-  CENTRALETA INCENDIS
-  DETECCIÓ AUTOMÀTICA (DETECTORS DE FUM)
-  DETECCIÓ AUTOMÀTICA DE FUMS PER BARRERES D'INFRAROIGS
-  POLSADOR AVIS D'INCENDIS
-  DETECTOR TERMOVELOCIMÈTRIC
-  SENYAL ACÚSTICA
-  ENLLUMENAT D'EMERGENCIA
-  SORTIDA D'EMERGENCIA
-  SORTIDA
-  PANTALLA INFRAROIGS CALEFACCIÓ (6 KW c.u.)
-  EXTRACTOR AIRE DIPÒSITS
-  EXTRACTOR SERVEIS (200W c.u.)
-  LOCAL RISC ESPECIAL ALT
-  LOCAL RISC ESPECIAL BAIX

Larix S.A. d'ENGINYERIA	TITULAR : FUNDACIÓ PRIVADA PER LA PROMOCIÓ DEL MUSEU DE LA TECNICA DE MANRESA	
Data : DESEMBRE 2011	<p>PROJECTE</p> <p>LLICENCIA AMBIENTAL EDIFICI DIPÒSITS VELLS</p> <p>SITUACIÓ: "Antics Dipòsits Vells" Ctra. de Santpedor, s/n 08242-MANRESA</p>	
El Peticionari :		
El Tècnic :		
DENOMINACIÓ : PLANTA GENERAL	Escales : 1 : 200	Núm. 2 Ref. 4.907